



# KROWNLAB

PDX - ORE



Sliding Door Hardware  
Installation Instructions  
Inger

## Double sided glass

- ① Reference the Glass Panel Specification document to confirm hole dimensions. For custom orders, also reference the relevant Custom Drawing.
- ② Insert rubber bushings in holes in glass panels
- ③ Install all mounting points without tightening fasteners all the way.
- ④ Ensure that all parts are lining up properly.
- ⑤ Tighten all fasteners.

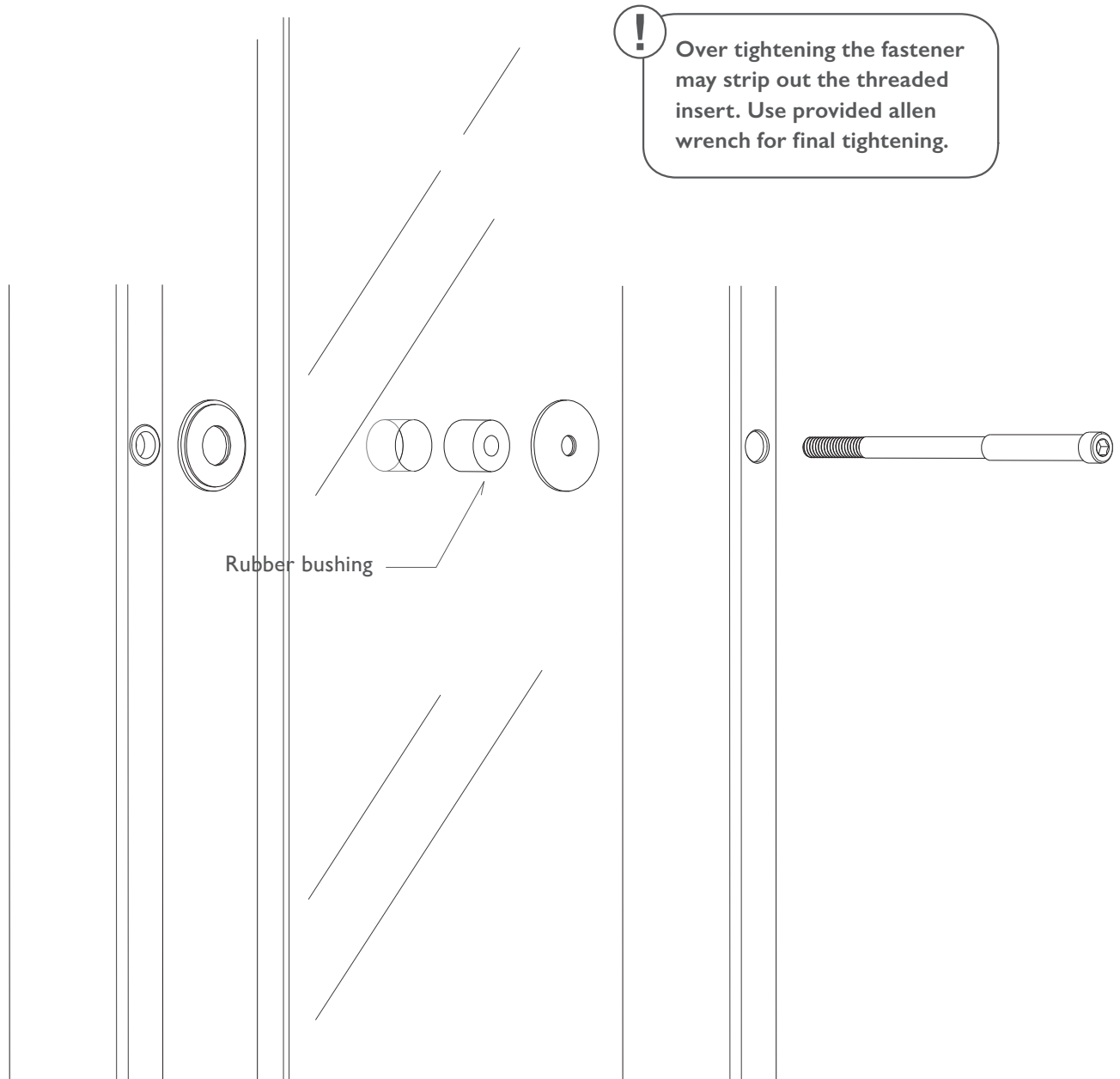

## Double sided

- ① Drill through holes in door panel at desired distance away from door edge.
- ② Install all mounting points without tightening fasteners all the way.
- ③ Ensure that all parts are lining up properly.
- ④ Tighten all fasteners.

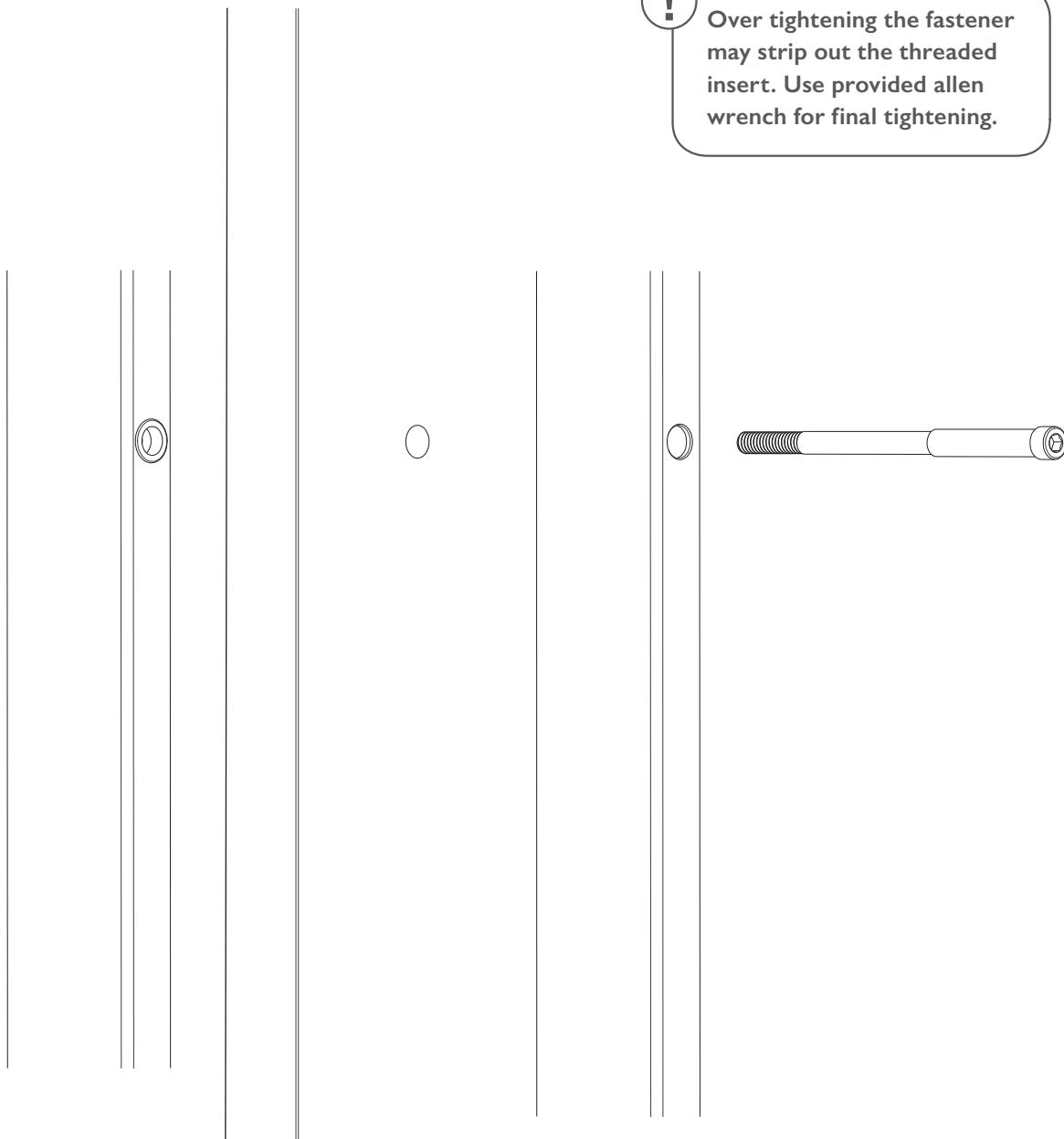
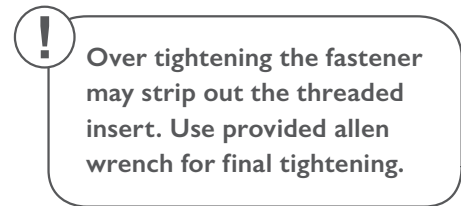

## Single sided glass

- ① Reference the Glass Panel Specification document to confirm hole dimensions. For custom orders, also reference the relevant Custom Drawing.
- ② Insert rubber bushings in holes in glass panels
- ③ Install all mounting points without tightening fasteners all the way.
- ④ Ensure that all parts are lining up properly.
- ⑤ Tighten all fasteners.

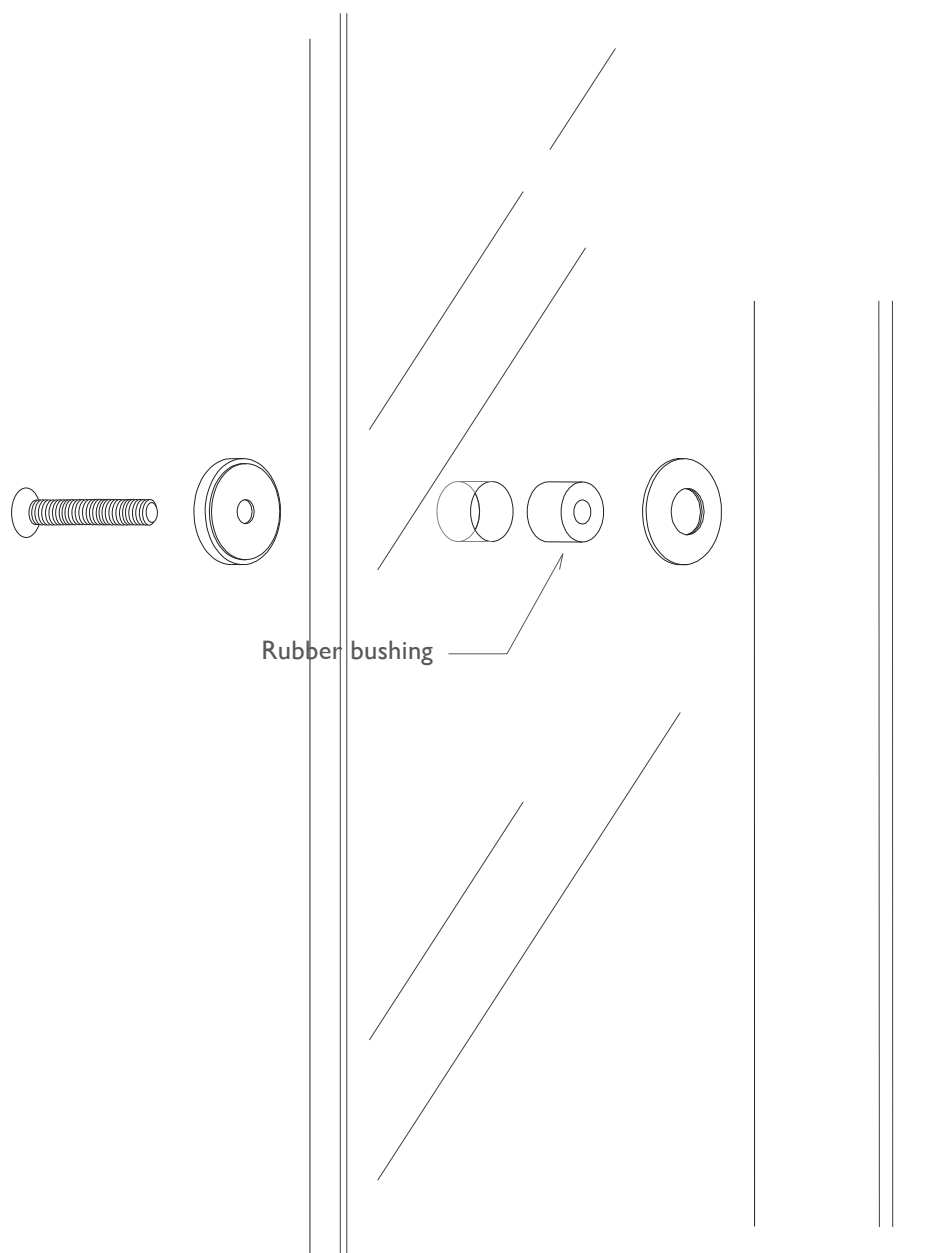

## Single sided

- ① Drill through holes in door panel at desired distance away from door edge
- ② Install all mounting points without tightening fasteners all the way.
- ③ Ensure that all parts are lining up properly.
- ④ Tighten all fasteners.

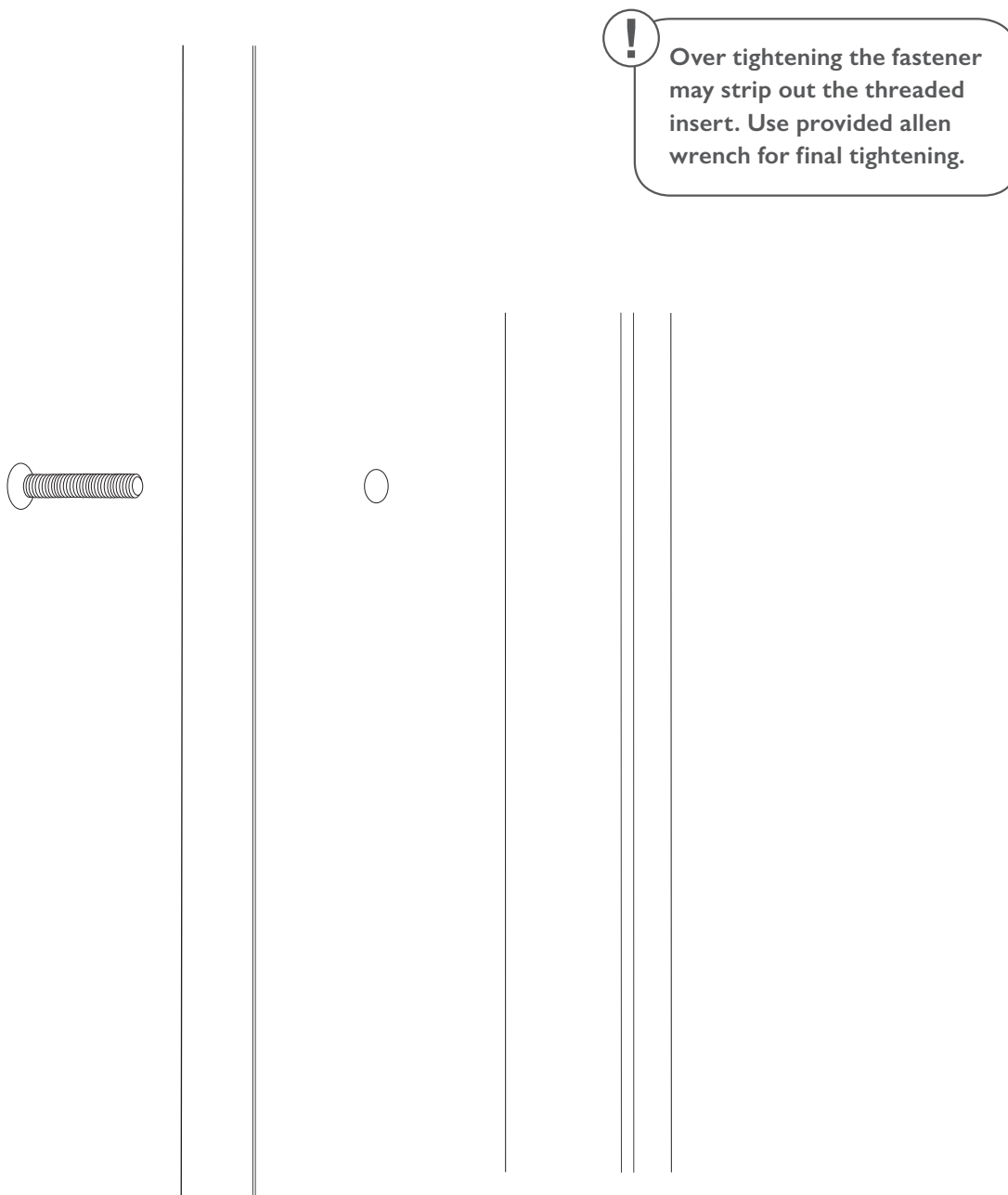

## Double sided glass with stand-offs

- ① Reference the Glass Panel Specification document to confirm hole dimensions. For custom orders, also reference the relevant Custom Drawing.
- ② Insert rubber bushings in holes in glass panels
- ③ Install all mounting points without tightening fasteners all the way.
- ④ Ensure that all parts are lining up properly.
- ⑤ Tighten all fasteners.

